



Stage Lighting Rules 2011

Royal South Street Competitions

The following Lighting Rules apply to all competitors in the Plays section, Dance Troupes and Calisthenics sections that permit the use of Fancy and Special lighting, subject to the specific rules for each section.

- All competitors in the sections listed above **MUST** complete a **LIGHTING CUE SHEET** (see below). Lighting Cue sheets are not required for sections, which use Standard lighting.
- Official Lighting cue sheets must be completed and returned to the Royal South Street Society office one week prior to the section. All forms **MUST** be sent via post **and not** emailed or faxed. (Calisthenic curtain forms must be sent at the same time as lighting forms).
- Competitors must recognise that non return of the lighting cue sheet will mean no special lighting, standard lighting only, on the spot demands for lighting not listed on the lighting cue sheet will not be possible.
- No extra lighting or special effects equipment may be used. Props they must be made available to the Her Majesty's Theatre Duty Technician for approval prior to the start of the section.**
- 12 cues only per item** are allowed. Up to Five (5) allowable lighting effects may be included in one cue (see Allowable lighting list and Sample Cue sheets attached), provided it is possible to operate the lighting cue with these requested effects.
- A separate official lighting cue sheet must be completed for each item in each section.
- For complicated lighting requirements a Plotting session is advised.

PLOTTING SESSIONS

- All plotting sessions must be booked through the Royal South Street Society office at least 3 days prior to the day the item is to be performed.
- Competitors will be charged **\$60** for a Plotting session of 20 minutes. Each Club/School may book a 20 minute maximum plotting session per division or age group (plotting sessions are booked in 30 minute blocks to allow time to save plotted data at the end of the session). **Please Note: Division 5, 6 & 7 sections over all age groups in Calisthenics must be called and plotting is not available.** Within a plotting session on 20 minutes it is estimated that only 2-3 items will be plotted. Championship Reserve & Senior Championship & will be allocated ONE (1) Hour in total and the price is \$120 or these sessions.
- During the dancing and calisthenic sections plotting sessions will only be held at night after competitions closes or in times that there is no competition scheduled. Plotting time may be available earlier in the competitions before these disciplines commence. Please check with the RSSS Office for availability.
- Plotting session times will be allocated at the discretion of the Royal South Street Society.
- Plotting sessions must be completed by the night before the day the item is to be performed.
 - * No plotting session will commence or continue after 2.00 am.
 - * Only coach and three assistants are allowed at the plotting session.

LIGHTING INFORMATION 2011

Cyc Colours: Now available to colour mix most colour. Base colours are Red, Green, Blue and Light Amber

Blinders: These can be used separately or together and are on OP and Prompt side.

Coloured lights DO NOT show up on black back curtain.

It is not possible to split colour on cyc.

Dress fill is included in the Front of House lighting and not a separate lighting effect.

Back light colours are: Pink, Green, Yellow and Purple.

Side lights are only Red and Blue. (These can be mixed to get Pink)

Washes are: Green, Amber, Red, Lavender, Blue and open white.

There is also a Downstage Open White strip of Light (Kick light at the stage edge).

Mirror ball has only one speed or else stopped.

Data projector does not work with full blinders, full front of house lights or full cyc lights but will work if used with a lower % of strength.

Follow spot: On the day to be used operator must see duty tech in a meal break for a run through. If you don't see the Duty Tech, you CAN NOT use it

Plotting requires a minimum of 2 people (Coach +1) and a maximum of 3 people (Coach + 2). A Coach needs at least one person on stage when plotting, in order to see how the lights effect faces. Some Coaches have come on their own, then been unhappy with the result on the day)

Prop lighting is NOT controlled by the lighting operator – the team must turn on and off item themselves.

ALLOWABLE LIGHTING

GENERAL LIGHTING

Stage wash - White or colours (Green, amber, red, lavender, blue, open white).
White is achieved by adding all the colours.

Cyclorama wash (back curtain) - black or coloured (red, blue, green and light amber), either in conjunction with or independent to Stage wash.

Side lights - pink or blue.

FIXED SPOTLIGHTS

Stage Spots - i.e. White spotlights fixed above the stage, which throw Cones of light to distinct circles onto the stage. There are 9 spots in 3 rows of 3. See figure.

Each change of combination of spotlights used is considered as part of one lighting cue.

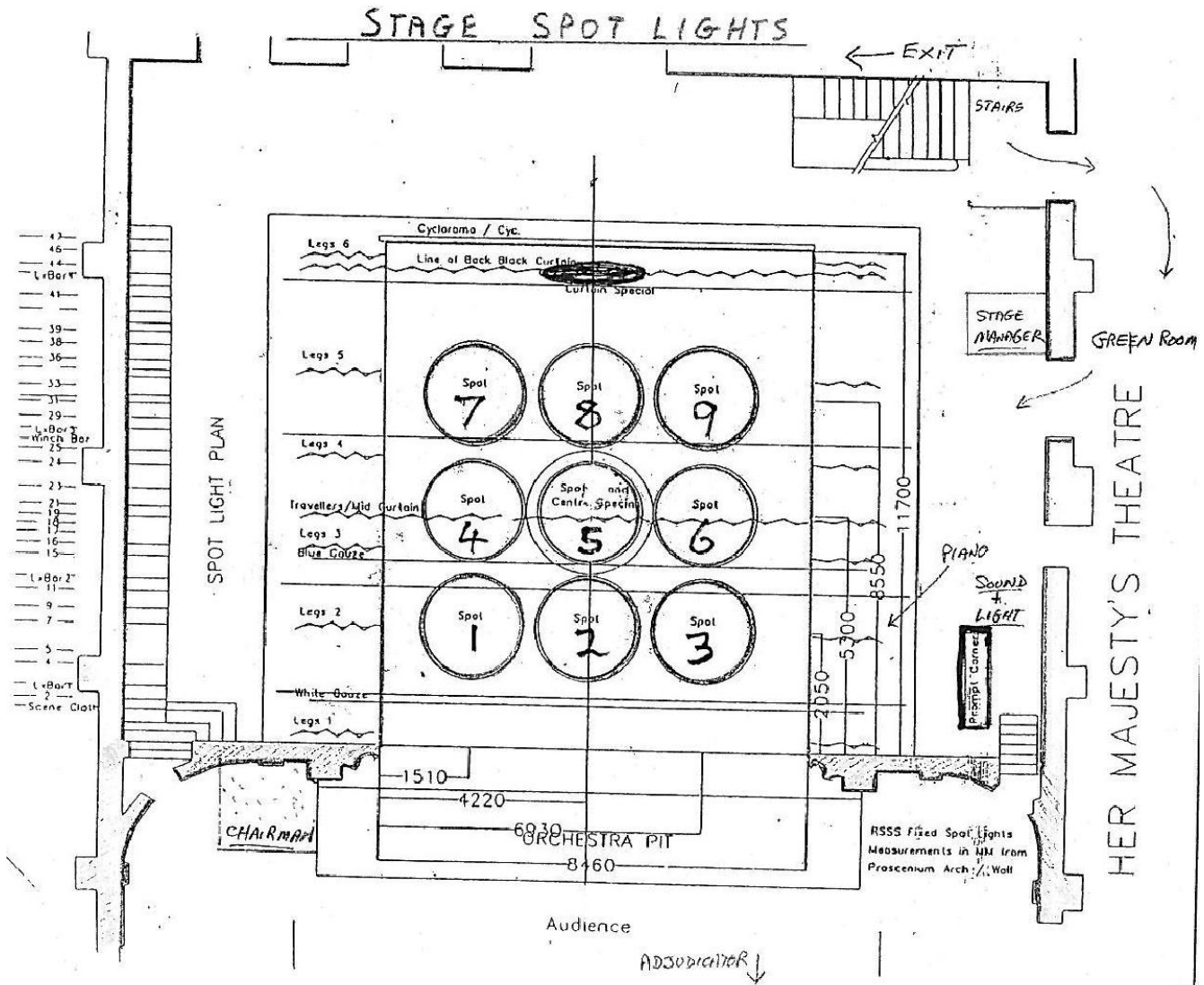

Centre special - a larger spot at centre stage, (over spot No. 5) suitable for groups.
Considered as part of one lighting cue.

Curtain special - illuminates the centre opening of the back black curtain. Used for entrances through the back black curtain. In fancy and special lighting items colored light may be used on the cyclorama. *Considered as part of one lighting cue.*

SPECIAL EFFECTS

U.V. (Ultra violet light) - supplied by R.S.S.S.

Mirror ball

Decal (dapple effect over the stage), with or without Stage wash.

Gobo (image projected onto the cyclorama). Standard choice supplied - rose, forest, stars, castle, waves, music notes, cross. Competitors are not permitted to provide their own Gobos. See separate gobo list for Calisthenics.

<u>Sub Juniors & Juniors</u>	<u>Intermediates</u>	<u>Seniors incl.Champ &.Champ Res</u>
Castle	Castle	Clouds
Stars	Stars	Stars
Christmas Tree	Music notes	Music Notes
Rose	City Skyline	City Skyline
Palm Trees	Birds	Flames
Witch on broomstick	Witch on broomstick	American Flag
Fireworks	Fireworks	Fireworks

Blinders (bright lights)- set in front corners of stage. (See Section conditions)

Curtains *A silver lame curtain is available for use. This curtain is situated on the line closest to the cyc and will not be moved to any other position. Please indicate on your Curtian sheet if you wish to use this curtain.*

Scrim curtains in fixed positions (Blue on Line 2, Black on line 15). Needs prior arrangement.

Considered as one cue. If a scrim curtain is to be used the item must have a Plotting session.

***In Calisthenics this is only available for Championship reserve and Senior Championship sections.*

Chase (rapid changing of colours of Stage or cyclorama wash.).

Considered as part of one cue.

FOLLOW SPOT

One follow spot only is available for use by Competitors who provide suitably qualified operators approved by the Her Majesty's Theatre Duty Technician. Please contact the RSSS Office for details.

ALLOWABLE PROPERTIES

Smoke Machine

For sections in which use of a Smoke Machine is allowed one may be hired from the Royal South Street Society at a cost of \$15 per competition item. Dry Ice Evaporators may not be used

Considered as part of one cue.



Example of Lighting Cue Sheet

Royal South Street Competitions 2011

Include Smoke requirements as necessary

CUE	DESCRIPTION	ACTION
	White Cyc. Backdrop line 39. Tree Gobo.	
1	Blue Wash, Amber Wash, Blue Sides, Decals, Green Cyc	Forest Morning
2	Centre Special on, Flash Generals and Cyc Lights	Storm effect with Music
3	Pink Wash, Amber Wash, Pink Sides, Blue/Green Cyc	Bright Sunshine
4	Red Wash, Amber Wash, Pink Sides, Red/ Yellow Cyc	Evening
5	Fade Down Generals, Fade Up Spots 1,3,5,7,9	Near End
6	Fade Up Curtain Special	on Exit
7	Blackout	Tabs Close.

IMPORTANT NOTES:

- A **separate sheet** must be completed for **each** competitor in each section.
- Lighting cue sheets must be completed and returned to the Royal South Street Society office at least one week prior to the section.
- Lighting sheets can only be the official 2011 CVI lighting sheet or the 2011 RSSS lighting cue sheet. NO OTHER sheets will be accepted.



Light Plotting Booking Form 2011

Royal South Street Westpac Calisthenics Competitions

NAME OF GROUP _____

CONTACT PERSON _____ EMAIL ADDRESS _____

NUMBERS (BH) _____ (AH) _____ Mobile _____

PLEASE NOTE: Plotting time will be allocated in order requests are received and confirmed by telephone. Teams performing the next day **will** be given preference.

Division	Age	Coach Plotting	Mobile or Contact Number	Performance Date	Preferred plotting Dates
EG. (Six)	(Senior)	(Jenny Smith)	(0418 000 000 or 9800 000 until 9pm)	(Tuesday 25 th October)	(Wednesday 12 th October or Thursday 20 th October)

PLOTTING SESSIONS

- All plotting sessions must be booked through the Royal South Street Society office at least 72 hours prior to the day the item is to be performed.
- There are only limited plotting times available. So we advise to get your request in early.
- Plotting session times will be allocated at the discretion of the Royal South Street Society.
- Coaches will be notified by telephone of plotting time allocated.
- Plotting sessions must be completed by the night before the day the item is to be performed.
- **If you have any queries you must contact the Royal South Street Office on 03 5332 1054 and NOT directly to the Theatre Technician**



Royal South Street Society Westpac Calisthenics Competition 2011

Curtains, Reveal and Props Booking Form

Club: _____ Section: _____ Division: _____ Date: _____

Item No	March	Curtains					Reveal		Props	Steps G, S, or B				Position of Steps
		House	Mid	Silver	Black	Cyc	Entry	Exit		1	2	3	4	
Item No	Clubs	Curtains					Reveal		Props	Steps G, S, or B				Position of Steps
		House	Mid	Silver	Black	Cyc	Entry	Exit		1	2	3	4	
Item No	Free Exercises	Curtains					Reveal		Props	Steps G, S, or B				Position of Steps
		House	Mid	Silver	Black	Cyc	Entry	Exit		1	2	3	4	
Item No	Rods	Curtains					Reveal		Props	Steps G, S, or B				Position of Steps
		House	Mid	Silver	Black	Cyc	Entry	Exit		1	2	3	4	

* This form must be returned by post with your Lighting Sheets.
 * Headsets can be used if required.



Royal South Street Society Westpac Calisthenics Competition 2011

Curtains, Reveal and Props Booking Form

Club: _____ Section: _____ Division: _____ Date: _____

Item No	Aesthetics/ Rhyth/Aesth	Curtains					Reveal		Props	Steps G, S, or B				Position of Steps
		House	Mid	Silver	Black	Cyc	Entry	Exit		1	2	3	4	
Item No	Rhythmics/Fo lk Dance	Curtains					Reveal		Props	Steps G, S, or B				Position of Steps
		House	Mid	Silver	Black	Cyc	Entry	Exit		1	2	3	4	
Item No	Spectacular	Curtains					Reveal		Props	Steps G, S, or B				Position of Steps
		House	Mid	Silver	Black	Cyc	Entry	Exit		1	2	3	4	
Item No	Cal Revue	Curtains					Reveal		Props	Steps G, S, or B				Position of Steps
		House	Mid	Silver	Black	Cyc	Entry	Exit		1	2	3	4	

* This form must be returned by post with your Lighting Sheets.
 * Headsets can be used if required.